

PRODUCT SHEET – Fixed Bollard with Breakpoint System

Diam. 4.7 in Height 19.7-29.5 in

CAME GROUP

URBACO
ISO 14001

AUTOMATIC BOLLARDS

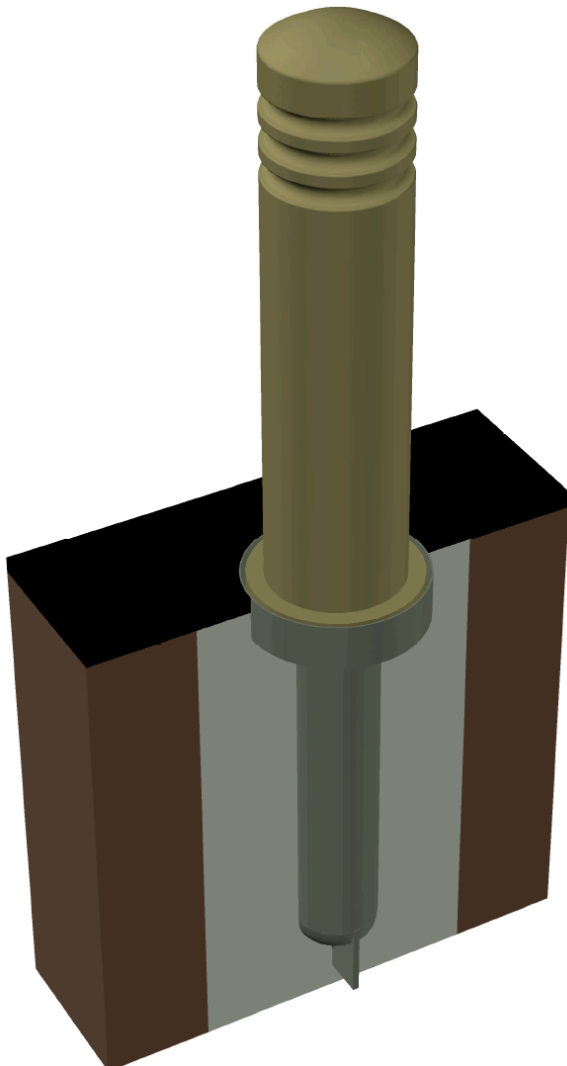

Impact Resistance	Weight (bollard)
---	44 – 57 lbs
Material	Average thickness (bollard)
Steel (socket base) Ductile cast iron (bollard)	.43 in

DESCRIPTION

Fixed bollards with breakpoint fuse system like any other fixed bollard can be used to delimit no-parking areas with the advantage of being able to resist the impact of a vehicle or to break loose, depending on impact force, without any deterioration for the bollard itself. It consists in cementing a socket base (4) in the ground; adjust the bollard (1) on the breakpoint fuse (3) with a distortion washer in between to absorb smaller shocks (2).

In case of a small shock or thrust, the bollard will lean (the washer distorts) but the breakpoint fuse is not broken. The bollard recesses into its initial position without any significant bending. In case of a more violent impact, the bollard leans, the breakpoint fuse shears apart and the bollard lies down. A linking thread (5) will keep the bollard attached to its socket base. It only takes a few minutes to replace the plastic breakpoint fuse.

Advantages:

- ✔ cementing is done simply and once for all;
- ✔ can be adapted to any kind of bollard Ø120 or post;
- ✔ economical in terms of maintenance (only the fuse is to replace);
- ✔ bollard is quickly back to initial state (less than 10 minutes);
- ✔ no need to redo tarring, quality surroundings preserved;
- ✔ no more nuisances during maintenance;
- ✔ bollards remain lined up in a perfect row.

By ordering art. «**BOBSEC**» in addition to the bollard article code, you get your removable bollard Ø120 transformed into a bollard with breakpoint fuse (all models, in height 19.7" or 29.5" in), as well as the socket base, the breakpoint fuse and the linking thread.

The fixed bollard with breakpoint system is a registered patent.

SURFACE FINISH (BOLLARD)

- Zinc primer to increase resistance to oxidation as well as to reinforce finishing coating adherence.

- Thermosetting polyester powder coating.

Standard colour: Charcoal grey RAL 7016, fine structure finish.

Option: other RAL shades

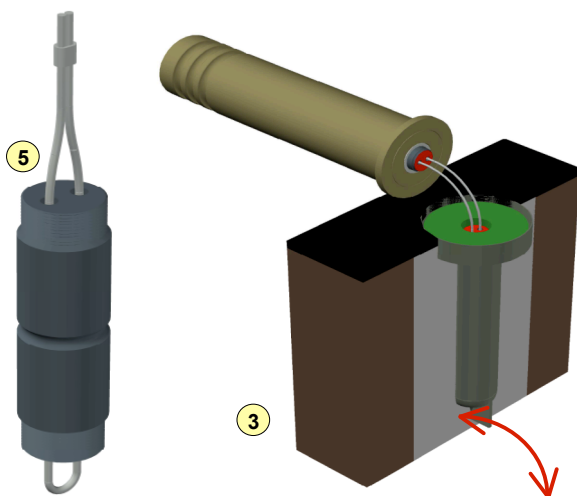

No more this!

Fuse was broken after impact.

Bollard lies down on the ground.

To get the bollard back into place:

- Remove (unscrew) that part of the fuse which remains inside the bollard head and the other part which is in the socket base with the key.
- Place the new fuse in the socket base with its linking thread, then screw the bollard head down onto the fuse.

The bollard is operational again.

- 1- Fixed bollard with breakpoint fuse
- 2- Distortion washer
- 3- Breakpoint fuse (replaceable)
- 4- Socket base
- 5- Thread linking bollard to socket base

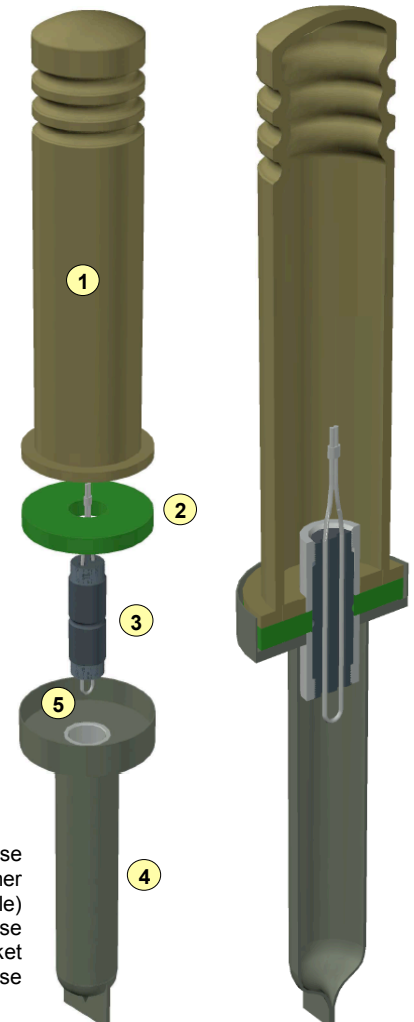

Urbaco Americas – A CAME Company
11345 NW 122nd Street | Medley, FL 33178
Tel. 305-433-3307 | Fax 305-396-3331
e-mail: info@urbaco-americas.com
www.urbaco-americas.com

FIXED BOLLARD