

PRODUCT SHEET – Fixed Bollards / LUXOR Range

Ø7.87 / Ø 10.62 / Ø12.52 in – Height: 23.6 / 31.4 in



Ø 7.870/23.60
32 lbs



Ø 10.62/H23.6
40 lbs



Ø12.52/H23.6
65 lbs



Ø7.87/H31.4
83 lbs



Ø10.62/H31.4
80 lbs

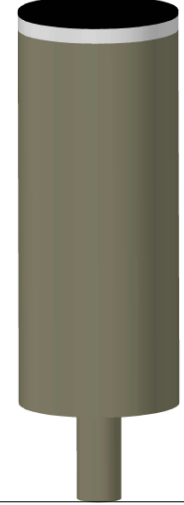

Ø12.52/H31.4
101 lbs

DESCRIPTION

The permanent fixed Luxor bollards are the obvious companion for automatic retractable Luxor bollards. They are the same diameters and the same heights as the whole range.

The surface finish is in complete harmony with Luxor automatic bollards too: black cap, white reflective band, RAL coating and varnish.

The range of fixed Luxor bollards covers three diameters (7.87, 10.62 and 12.52 in) and two heights (23.6 and 31.4). They are made of steel tubing, 0.15 to 0.23 in thick depending on model.

To cement the bollard base to the ground, a tube 3.54 in / 7.87 in long is welded to the flat bollard base. No need to bore a large hole in the ground, the tube being much thinner than the bollard head.

SURFACE FINISH

- ✔ Zinc primer to increase resistance to oxidation as well as to reinforce finishing coating adherence.
- ✔ Thermosetting polyester powder coating, 2 coating colours: black for the cap, and any RAL shade for the bollard head.
- ✔ Standard colors: RAL 3002 and RAL 7016
- ✔ Varnish finish

OPTIONS

- ✔ Colors: any RAL shade available
- ✔ Fixed eyelets and chains

LUXOR FIXED BOLLARD MODELS

	Ø7.87	Ø10.62	Ø12.52
H23.6	BSLUXE60	BSLUXF60	BSLUXG60
H31.4	BSLUXE80	BSLUXF80	BSLUXG80
THICKNESS >>	0.23 in	0.23 in	0.23 in

Urbaco Americas – A CAME Company
 11345 NW 122nd Street | Medley, FL 33178
 Tel. 305-433-3307 | Fax 305-396-3331

e-mail: info@urbaco-americas.com | www.urbaco-americas.com

Resistance

Depending on cementing

Weight

from 32 lbs to 101 lbs

Material

Steel

Thickness (bollard head)

from 0.15 to 0.23 in

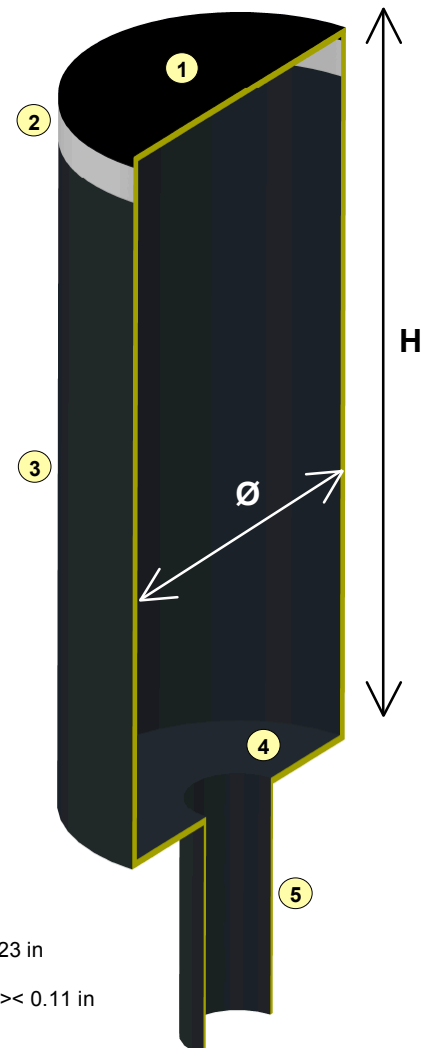

Caption:

- 1- Cap, >< 0.23 in
- 2- Reflective band, white
- 3- Bollard head, >< 0.15 to 0.23 in
- 4- Flat base, >< 60.23 in
- 5- Tube for cementing Ø3.54 >< 0.11 in